

Interferometer

Efficient Alternative to Measuring Phase

Two operation modes:

- *Self Referencing Mode*
 - Use the source output as a reference beam
- *Fiber or Free-space Mode*
 - Use a Fiber or Free-space laser as a reference
- Can be configured for any wavelength
- Uses standard silicon cameras in most cases
- Compatible with most optical tables and lab supplies
- Versions available for less than \$5k

“Years of development for previous customers”

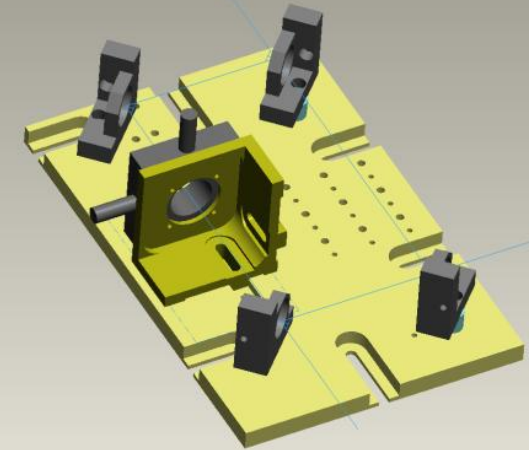

Mach-Zender Self Referencing Mode

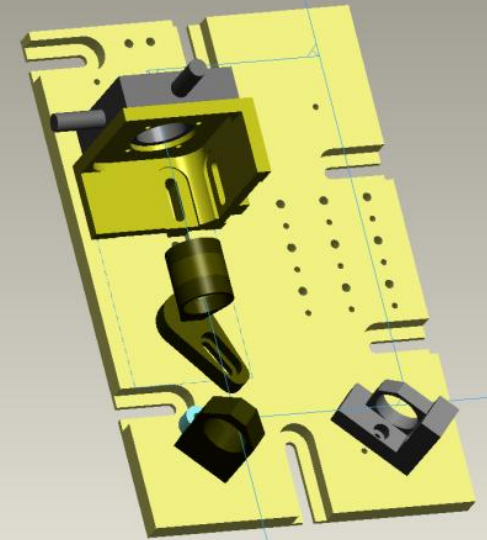

Fiber / Free-Space Reference Mode

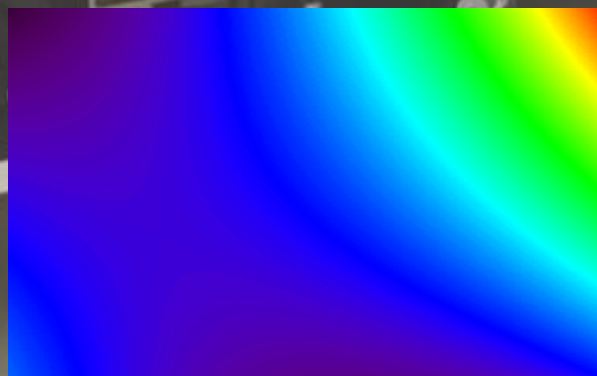
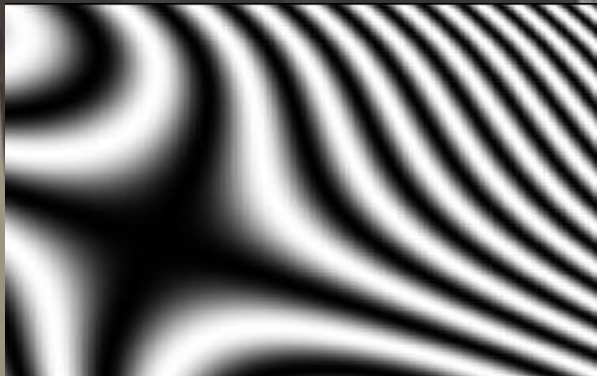

Capture Fringe Patterns => And Convert to Phase Maps

Neil Vanasse

- *Optical Engineer*
- *Mechanical Engineer*
- *Lab-Technician and Test Engineer*

Neil.Vanasse@truefocusengr.com

720-276-2326