

AEROSPACE INDUSTRIES ASSOCIATION OF AMERICA, INC.
10000 WILSON BOULEVARD, SUITE 1700
ARLINGTON, VA 22209-3901

FED SUP CLASS
5310

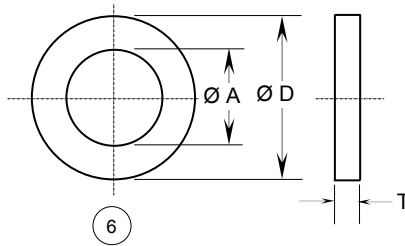

THREAD SIZE (REF)	SIZE CODE (a)	T THICKNESS	DIA A +.010 -.000	DIA D +.015 -.005
NO.0 (.0600)	0	.016	.063	.099
NO.2 (.0860)	2	.016	.089	.149
NO.3 (.0990)	3L	.016	.102	.180
NO.3 (.0990)	3	.032	.102	.180
NO.4 (.1120)	4L	.016	.115	.209
NO.4 (.1120)	4	.032	.115	.209
NO.5 (.1250)	5L	.016	.128	.238
NO.5 (.1250)	5	.032	.128	.238
NO.6 (.1380)	6L	.016	.143	.267
NO.6 (.1380)	6	.032	.143	.267
NO.8 (.1640)	8L	.016	.169	.304
NO.8 (.1640)	8	.032	.169	.304
NO.10 (.1900)	10L	.032	.195	.354
NO.10 (.1900)	10	.063	.195	.354
¼ (.2500)	416L	.032	.255	.468
¼ (.2500)	416	.063	.255	.468

(a) "L" CODING IN TABLE IDENTIFIES THE LIGHT SERIES OF WASHERS. (6)

MATERIAL: LOW CARBON STEEL SHEET OR STRIP IN ACCORDANCE WITH QQ-S-698, COLD ROLLED COMMERCIAL QUALITY, NO. 1 FULL HARD TEMPER OR NO. 2 HALF-HARD TEMPER, NO. 3 FINISH.

5052 ALUMINUM ALLOY SHEET IN ACCORDANCE WITH AMS-QQ-A-250/8 (UNS A95052), TEMPER H32 OR TEMPER H34.

COMMERCIAL BRASS SHEET OR STRIP IN ACCORDANCE WITH ASTM B36 OR ASTM B121, HALF-HARD TEMPER (6)

CORROSION-RESISTANT STEEL SHEET OR STRIP IN ACCORDANCE WITH ASTM A 240, ANY OF THE 300 SERIES, CONDITION A FINISH 2D OR 2B (FOR SHEET), FINISH 2 (FOR STRIP).

(6) NITRONIC 60 CRES BAR PER AMS 5848 OR ASTM A 276 (UNS S21800) OR NITRONIC 60 SHEET PER ASTM A 240 (UNS S21800).

LIST OF CURRENT SHEETS	
NO.	REV.
1	6
2	2

THIS DRAWING SUPERSEDES ALL ANTECEDENT STANDARD DRAWINGS FOR THE SAME PRODUCT AND SHALL BECOME EFFECTIVE NO LATER THAN SIX MONTHS FROM THE LAST DATE OF APPROVAL SHOWN HEREON.

CUSTODIAN	NATIONAL AEROSPACE STANDARDS COMMITTEE	PROJECTION THIRD ANGLE	
PROCUREMENT SPECIFICATION	TITLE WASHER, FLAT – REDUCED OUTSIDE DIAMETER	CLASSIFICATION PART STANDARD NAS620	
NONE		SHEET 1 OF 2	

APPROVAL DATE 31 MAY 1956 REVISION (1) 31 OCT 1961 (2) 15 NOV 1962 (3) 30 JUNE 1981 (4) 15 APRIL 1987 (5) 9 DEC 1992 (6) SEPT. 2006

AEROSPACE INDUSTRIES ASSOCIATION OF AMERICA, INC.
10000 WILSON BOULEVARD, SUITE 1700
ARLINGTON, VA 22209-3901

- FINISH:
- LOW CARBON STEEL - CADMIUM PLATE IN ACCORDANCE WITH AMS-QQ-P-416, TYPE II, CLASS 2.
 - ALUMINUM ALLOY - NONE. (2)
 - BRASS - CADMIUM PLATE IN ACCORDANCE WITH AMS-QQ-P-416, TYPE II, CLASS 2.
CADMIUM PLATED BRASS WASHERS ARE TO BE DYED A LIGHT BLUE COLOR WHICH WILL NOT RUB OFF OR BE SMEARED BY CONTACT INCIDENTAL TO HANDLING AND SERVICE, AND SHALL NOT BE INJURIOUS TO THE MATERIAL.
 - CORROSION RESISTANT STEEL (2) - PASSIVATE IN ACCORDANCE WITH AMS2700, METHOD 1, TYPE 6, CLASS 1.
- BLACK OXIDE COAT PER MIL-DTL-13924. (2)
 - (2) NITRONIC 60 - PASSIVATE IN ACCORDANCE WITH AMS2700, METHOD 1, TYPE 6, CLASS 1.

- MATERIAL CODE:
- "-" - LOW CARBON STEEL.
 - "A" - ALUMINUM ALLOY.
 - "B" - BRASS.
 - "C" - CORROSION-RESISTANT STEEL
 - (2) "N" - NITRONIC 60

- FINISH CODE: (2) "P" - INDICATES BLACK OXIDE COATED FOR CORROSION-RESISTANT STEEL ONLY.

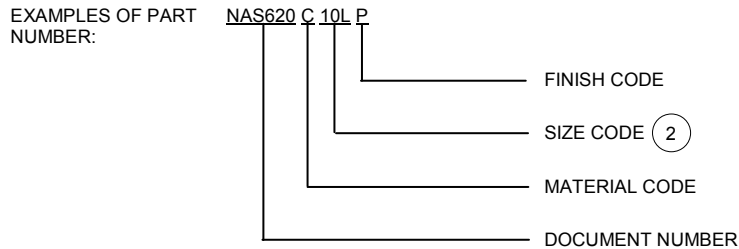

- NAS620-10 - NO. 10 STEEL WASHER, CADMIUM PLATED, .063 INCH THICK.
- NAS620A10L - NO. 10 ALUMINUM ALLOY WASHER, LIGHT SERIES, .032 INCH THICK.
- NAS620B10 - NO. 10 BRASS WASHER, CADMIUM PLATED, DYED LIGHT BLUE, .063 INCH THICK.
- NAS620C10 - NO. 10 CORROSION-RESISTANT STEEL WASHER, PASSIVATED, .063 INCH THICK.
- NAS620C10P - NO. 10 CORROSION-RESISTANT STEEL WASHER, BLACK-OXIDE COATED, .063 INCH THICK.
- (2) NAS620N10 - NO. 10 NITRONIC 60 WASHER, .063 INCH THICK.

NOTES: UNLESS OTHERWISE SPECIFIED (2)

1. DIMENSIONS IN INCHES.
- (2) 2. TOLERANCES:
ALL WASHERS MUST BE FLAT WITHIN .007 INCH AND PARALLEL WITHIN .002 INCH.
TOLERANCE ON THICKNESS "T" IS TO BE IN ACCORDANCE WITH THE SHEET TOLERANCE REQUIREMENTS OF THE APPLICABLE MATERIAL SPECIFICATION.
3. REMOVE ALL BURRS AND SHARP EDGES BEFORE PLATING. DIMENSIONS SHALL BE MET AFTER PLATING.
4. USE MS15795 WASHERS OR NAS1149 WASHERS WHENEVER PRACTICAL. (2)
5. THESE WASHERS ARE PRIMARILY FOR USE TO MOUNT COMPONENTS IN AREAS OF BEND RADII AND OTHER INTERFERENCES
6. REFERENCED DOCUMENTS SHALL BE OF THE ISSUE IN EFFECT ON DATE OF INVITATION FOR BID.
7. THIS STANDARD TAKES PRECEDENCE OVER DOCUMENTS SPECIFIED HEREIN.

THIS DRAWING SUPERSEDES ALL ANTECEDENT STANDARD DRAWINGS FOR THE SAME PRODUCT AND SHALL BECOME EFFECTIVE NO LATER THAN SIX MONTHS FROM THE LAST DATE OF APPROVAL SHOWN HEREON.

APPROVAL DATE APRIL 1987 REVISION (1) 9 DEC 1992 (2) SEPT. 2006